



REUNION

I N I T I A T I V E

**But while he was still a long way off,
his father saw him and felt compassion,
and ran and embraced him and kissed him.**

Luke 15:20b



Welcome to the Reunion!

There is something truly beautiful about a reunion whether it is...

- The university student coming home for the holidays -or-
- The child, momentarily lost in the grocery store, tearfully embracing her mother -or-
- The recovering addict connecting again with his siblings and meeting his nephews for the first time -or-
- The soldier returning from deployment to signs and shouts of joy

Every time someone “a long way off” is reunited with their family, it can remind us of THE great story all over again. While we were a still a long way off, Jesus reached out to rescue us and draw us near to our Heavenly Father! This is the GOOD NEWS that has driven GBC for over 80 years in this area and around the world. By God’s grace, many lives have been impacted by the ministry of this church through the decades!



The Challenge

In the last 10 years, our family “reunion” has grown quite substantially as many more people have been invited to know the truth of our Father’s love and participate in Christ’s great work. It has been truly wonderful, but at times, has also posed some real challenges.

- We are currently running 3 Sunday worship services and are in need of a 4th.
- We have 40+ grace groups, but only 2 dedicated spaces where they can meet.
- We regularly tell outside groups “no” for lack of adequate space (recovery groups, campus ministries, etc.)
- Our kids’ ministry is spread all over the building.
- We have space for only 1 adult class per hour.
- The Catalyst youth ministries have outgrown the “BOX,” and are currently meeting in the sanctuary on Sunday nights.
- Our sports outreach ministry is limited to good weather/ field conditions.





The Vision

As we look around at our faith family and consider the many more people in our area who do not yet know Jesus, we long for a bigger REUNION... a place where we can gather and invite others to join us. In order to do this, we are proposing a **building project** that will add substantial space to our current building and open up many more opportunities for ministry in Ann Arbor and beyond.



Project Basics

A 3 Phase building project will add over 30,000 sq. feet of new ministry space, retrofit and expand current ministry spaces and add additional parking, driveways and sidewalks.



General Contractor: Schmina Construction
Site plan approved by the city of Ann Arbor
Proposed Construction start date: June 1, 2022

Project Highlights

Phase 1: A family ministries center and additional parking (9 months)



- A significantly larger kids' space that is able to be completely secured
 - An indoor kids' playground
- A full (NCAA sized) basketball court with tech for future events and room for bleachers

- A dedicated youth group room that is 2x the current space and is close to the new catering kitchen and gym
 - Additional bathrooms
 - 50 new parking spots

Project Highlights

Phase 2: An expanded sanctuary (6 months)

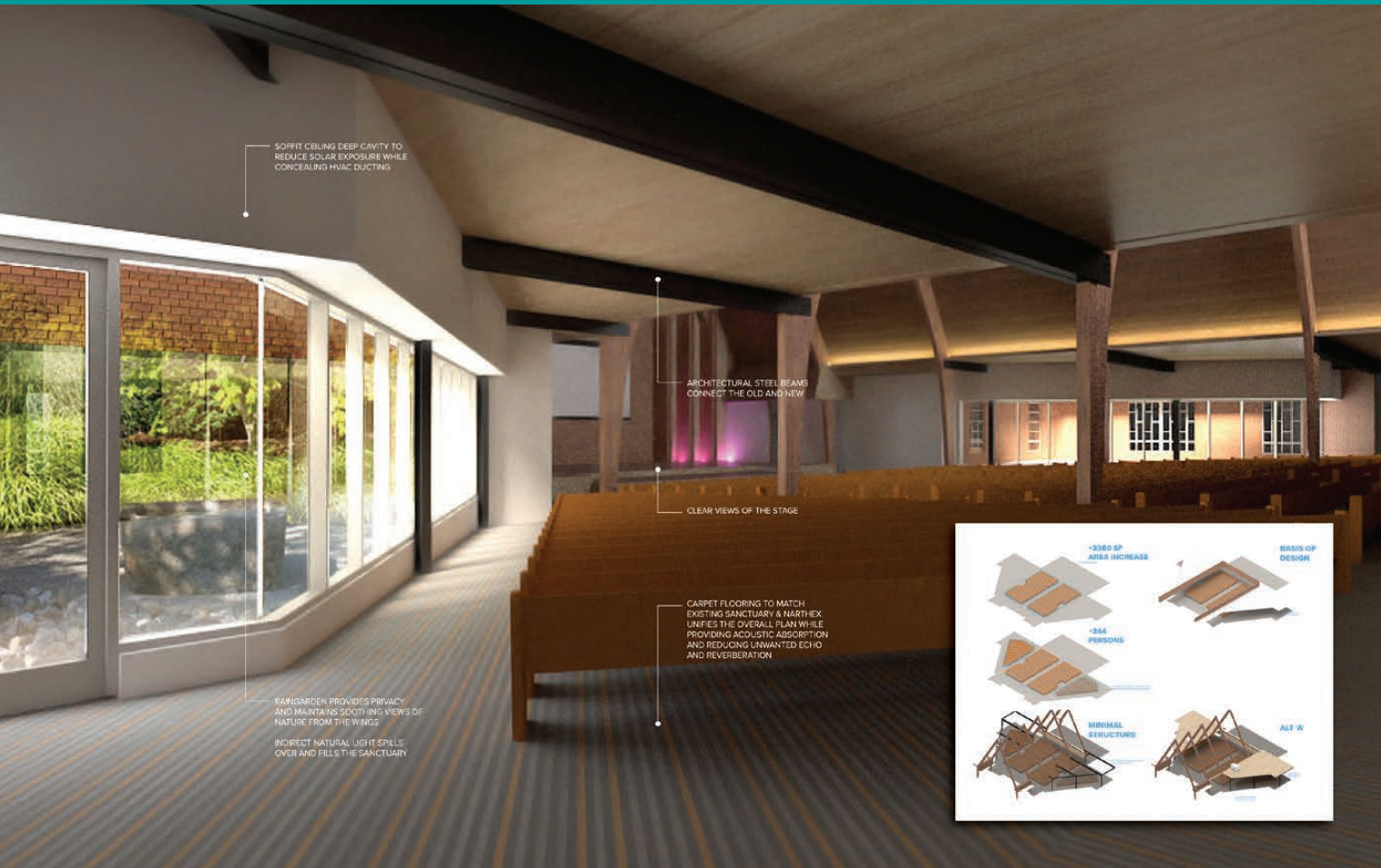

- An additional 250 seats
- Upgraded sound tech to accommodate the larger room
- Reconfigured courtyards

Project Highlights

Phase 3: Retrofitting, parking and pavilion (3 months)

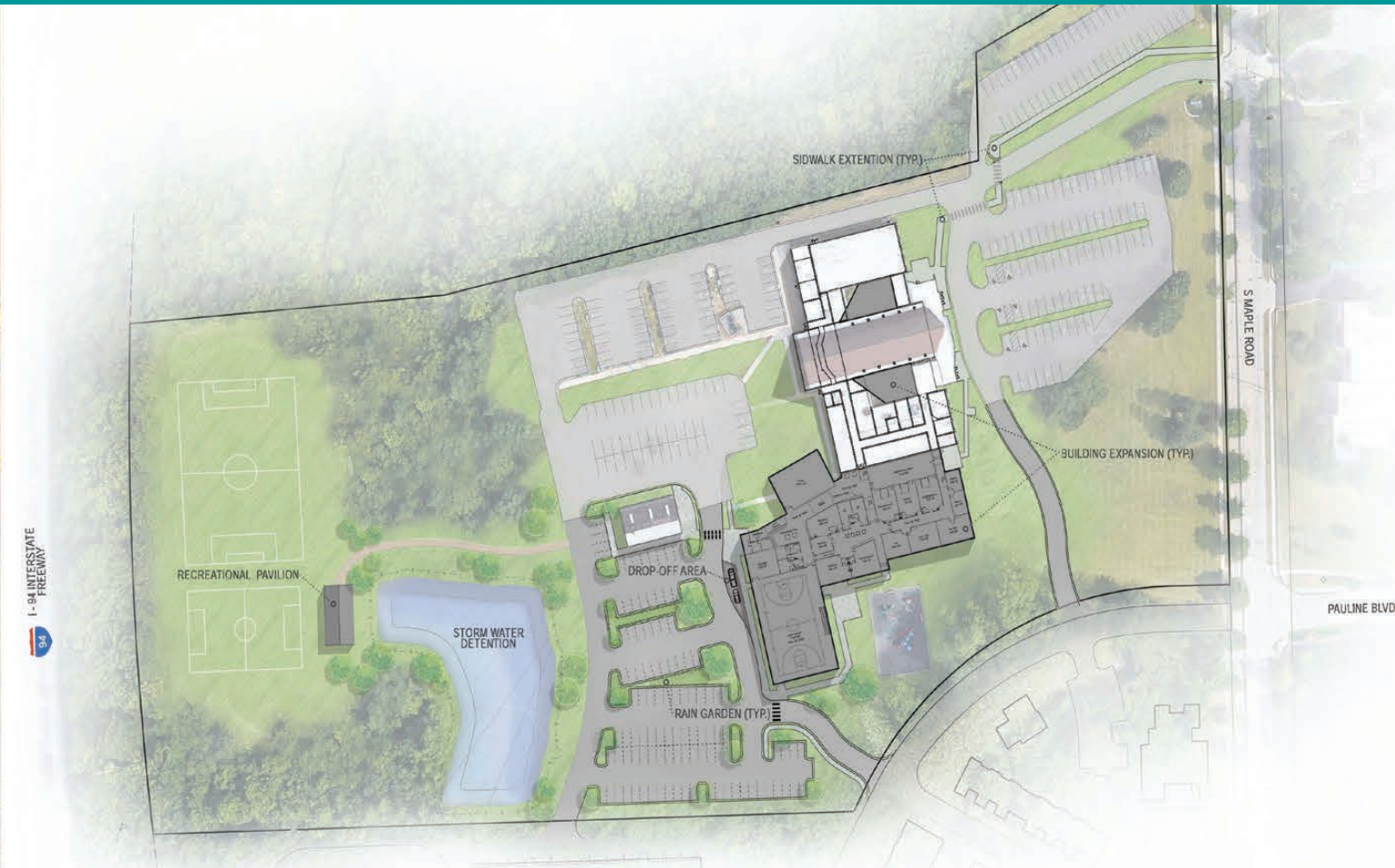

- An additional 50 new parking spots as well as resurfacing the rest of the parking lot
 - Fellowship Hall space dedicated to adult ministries and conferences
 - Numerous classrooms retrofitted for small groups meeting spaces and offices
 - A dedicated space for outside groups to meet (the BOX)
 - A pavilion and upgraded soccer fields

The Financial Goal

Through the sale of some adjacent land, consistent thoughtful budgeting, and your ongoing generosity, we believe that we are in a great position to make this vision a reality. On top of what we have been able to save, we are seeking to raise \$3.5 million in order to complete all 3 phases.

In order to raise this money, we will need people to pray, discuss and decide how they might be part of this project. We are all called to be wise stewards and cheerful givers, and we are excited to see how this initiative continues to transform us more into the likeness of Christ. In order to reach our goals, we will need people giving at all different levels.

Number of Gifts	Amount of Each Gift
1	\$350,000
1	\$250,000
1	\$200,000
2	\$150,000
2	\$100,000
4	\$75,000
5	\$50,000
30	\$25,000
35	\$10,000
45	\$7,500
50	\$5,000
50	\$2,500
50	\$1,250

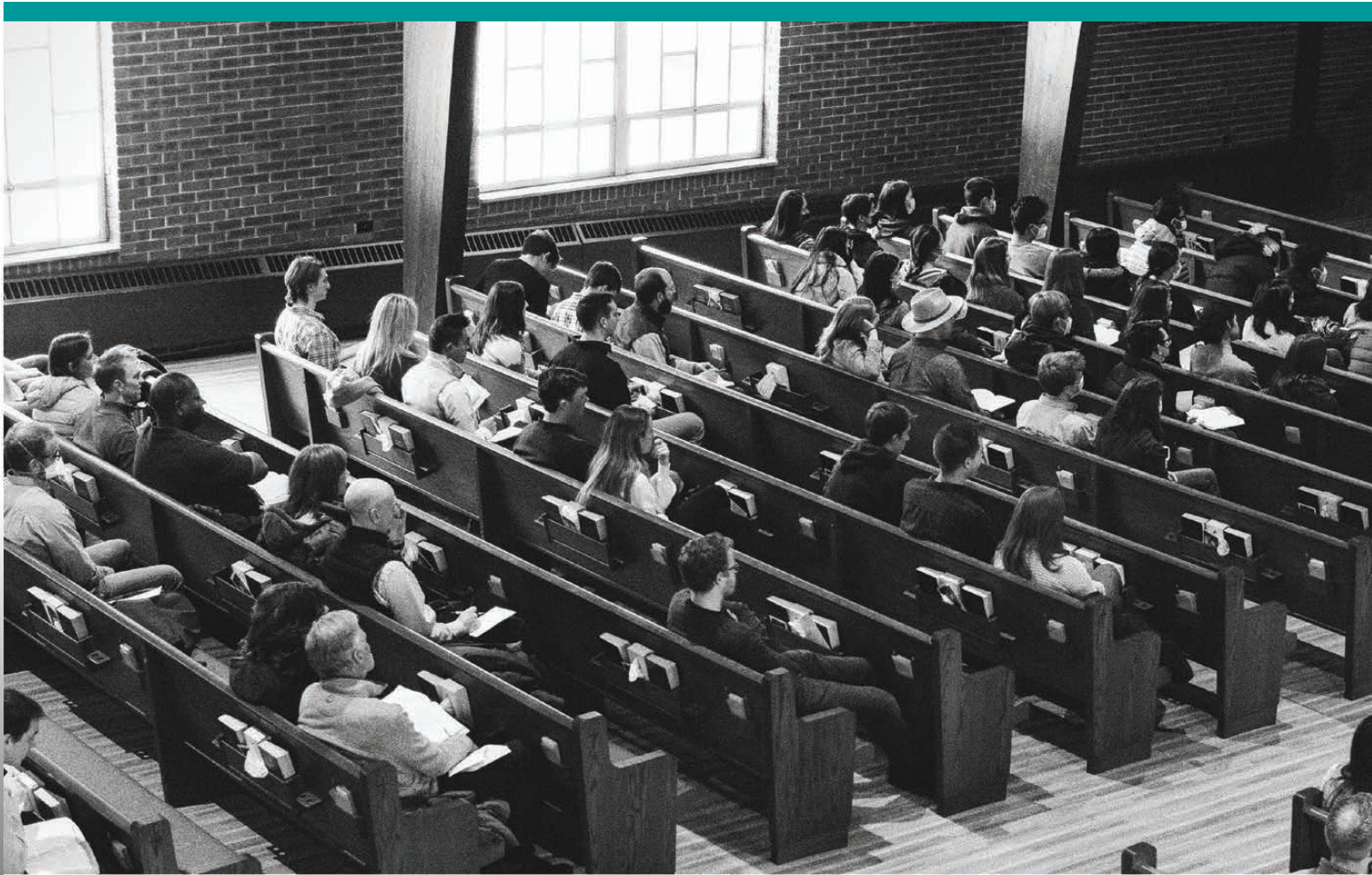

FAQ's

The timelines for each of the phases are 9 months, 6 months and 3 months respectively. Does this mean that the entire project will take 18 months to build from start to finish?

Not necessarily. The duration of the project is somewhat dependent on how much of the funds are raised. In an ideal scenario, we will get enough commitments so that some of these projects can be worked on simultaneously. This would mean that the entire project may be completed in a shorter time frame.

\$3.5M seems like a lot of money; what guardrails are in place to ensure that we don't overextend ourselves financially?

We have contingency fees built into the total cost. We selected a contractor early in this project and are working with them every step along the way to make sure that we have a good idea of the costs. Also, we are committed to keeping a healthy prudent reserve in the bank at all times (6+ months of operating budget).

What happens if we do not raise the entire amount of money? Will we potentially borrow funds to complete the project?

We will have the option to borrow what we are unable to raise; however, the elder board is taking a cautious approach in considering this option.

What is our indebtedness currently?

We do not have any debt.

This building will be double the size of our current building which means there will be more utility costs/cleaning costs etc. How will we handle this?

Along with adding space, we are also upgrading some of our entire building's utility systems and windows which will allow us to be more efficient per sq. foot. Also, in order to be sufficiently prepared, we are raising our utilities budget this fiscal year (starting in July), in order to handle any additional costs. Our current giving is in an extremely healthy place to take on potential new costs.

When will the fundraising be happening?

We will have a 3 year campaign starting in May 2022 and ending in May 2025.

Are my gifts to this initiative supposed to replace my current giving, or is this "over and above"?

We are seeking to raise these funds "over and above" our current giving.

Let's be real though, won't people giving to this initiative have a negative effect on funding for our annual budget?

We don't think so. Studies show that capital campaigns generally do not have a negative impact on a growing church. This was GBC's experience with our previous campaign in 2016-2017. Not only did we raise enough money for the project, our annual budget and income increased during the campaign.

Can I give appreciated stock or property or distributions or donate through a charitable trust?

Yes! In many cases, this is the most tax-advantaged way to give. Our business office is very capable of helping you process complex charitable gifts and is available to answer any questions you may have. Please do not hesitate to reach out to Carol Burgener (cburgener@gracea2.org) or call the office (734) 663-0589 with your questions.

How can I give?

I am glad you asked! We have included a commitment card for you to prayerfully consider. We will be collecting these cards in person beginning in May 2022, but you are also welcome to go online by scanning the QR code and committing online.

We are so excited for what God has in store for us!





Ways to be Involved

Intercede

More than a building, we are asking the Spirit of God to continue to move. May God give each of us wisdom, generosity and the ability to see His hand at work.

Invite

Although we are tight on space, each of us must continually be on mission for Christ, gathering together and inviting others to know our great heavenly Father as part of the family of faith.

Invest

Through generous giving, you can make it possible for our growing family to continue to gather for years to come.





REUNION

I N I T I A T I V E

Grace Bible Church

1300 S. Maple Road • Ann Arbor, MI 48103
734.663.0589 • gracea2.org